

POR. SEC. 3, T01S, R01W, S.M.

145-025

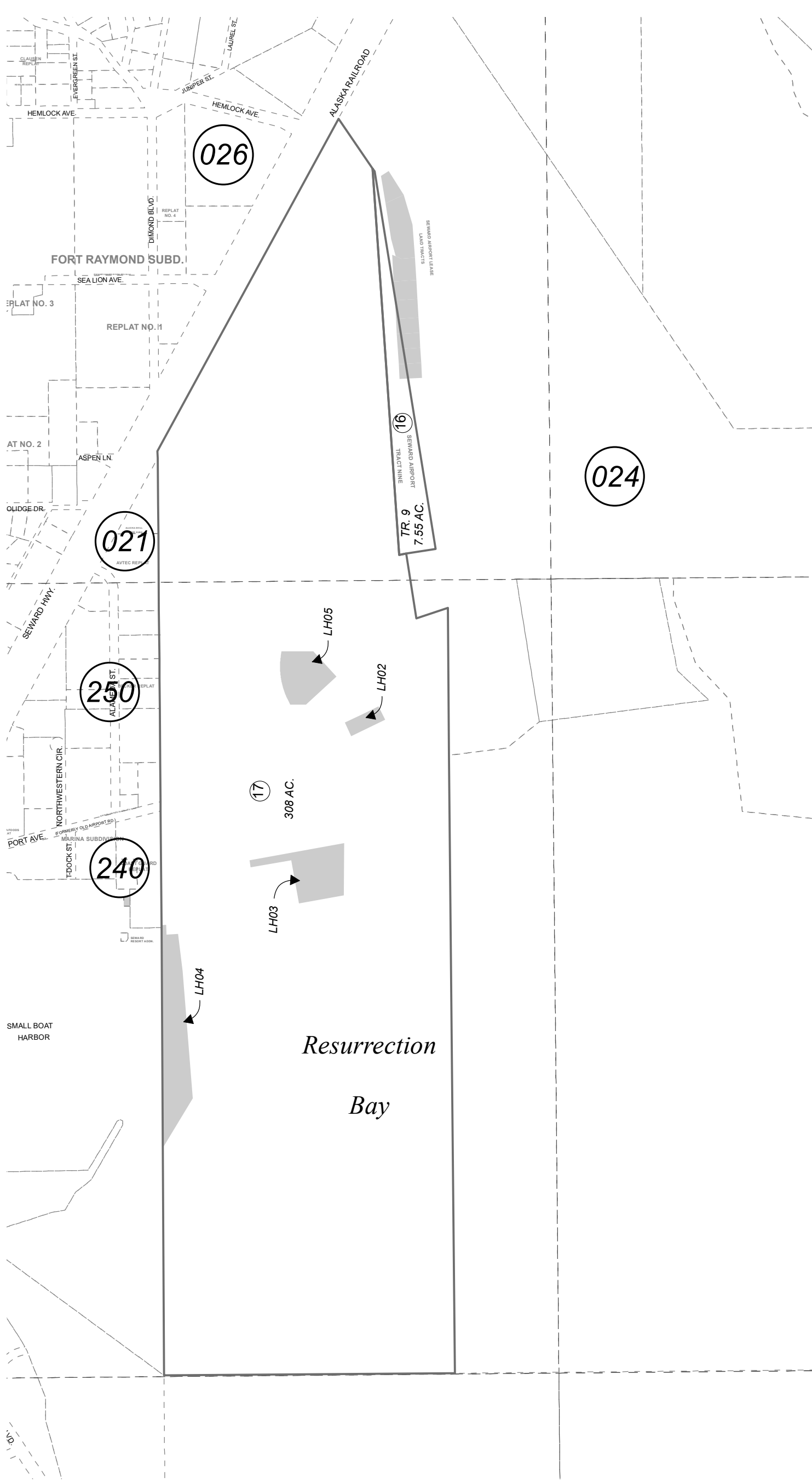

JANUARY 4, 2024

For 2024 assessment roll		
Delete	Add	Revise
		To
		17
(ACREAGE REVISION)		

0 200 400 800 Feet



This map is prepared for Kenai Peninsula Borough Assessing Dept. use only and is not intended for conveyance nor is it a survey.

Note- Assessor's block Numbers Shown in Ellipses  
Assessor's Parcel Numbers Shown in Circles

Assessor's Map  
Kenai Peninsula Borough  
SEWARD AIRPORT TRACT NINE SW0940035