

010

160

170

250

140

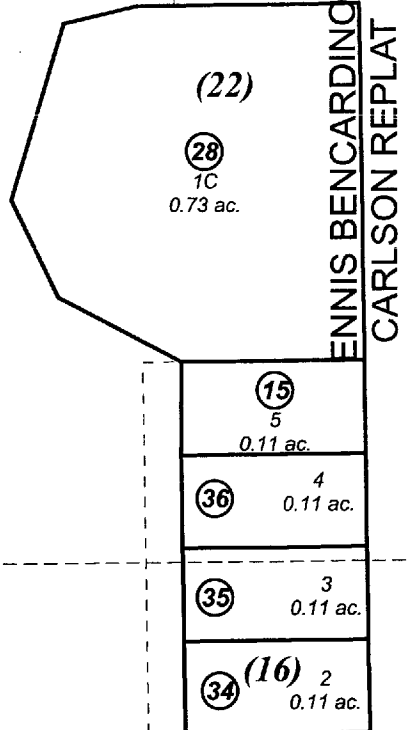

JANUARY 20, 2011

For 2011 assessment roll		
Delete	Add	Revise
	To	
10-13, 16,17		34-36



Assessor's Map
Kenai Peninsula Borough

FEDERAL ADDN TO SEWARD SW0000004
 FEDERAL ADDN TO SEWARD ENNIS REPLAT SW0890001
 FEDERAL ADDN TO SEWARD BLUM ADDN SW0940020
 OCEANVIEW SUBD AMBULANCE CORPS REPLAT SW0960006
 FEDERAL ADDN TO SEWARD ENNIS REPLAT NO 2 SW2001012
 SEWARD TOWNSITE ENNIS BENCARDINO CARLSON REPLAT SW2004011
 FEDERAL ADDN TO SEWARD CLARK-TOUGAS REPLAT SW2007004

This map is prepared for Kenai Peninsula Borough Assessing Dept. use only and is not intended for conveyance nor is it a survey.
 Note- Assessor's block Numbers Shown in Ellipses
 Assessor's Parcel Numbers Shown in Circles