

NOTE:
SEWARD AIRPORT LEASED
LAND TRACTS RESIDE ON
PARCEL NO. 145-024-01

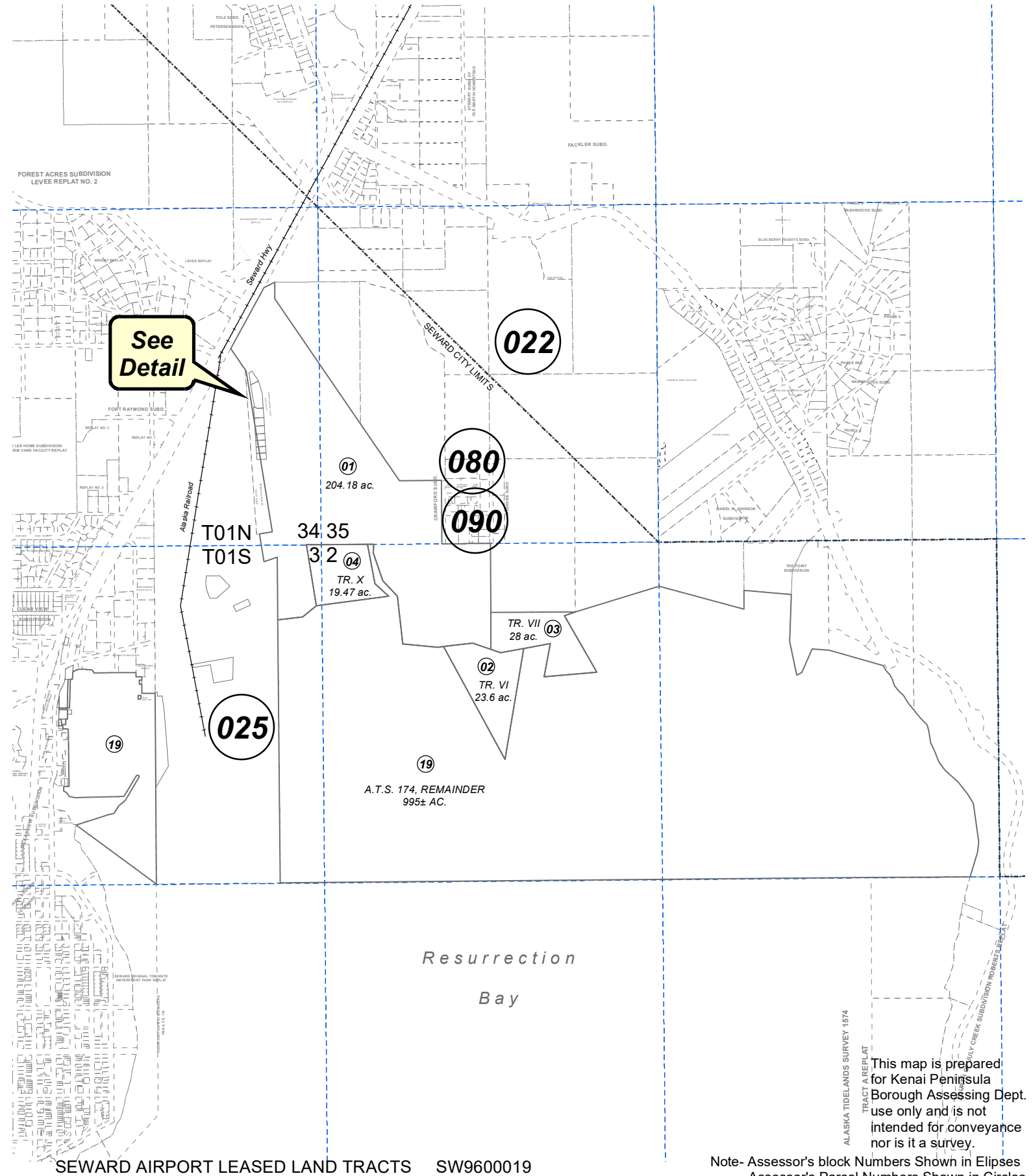

See
Detail

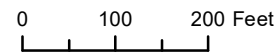
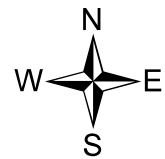

AUGUST 2, 2022

For 2023 assessment roll		
Delete	Add	Revise
To		19
(ADDED REMAINDER A.T.S. 174)		

Assessor's Map
Kenai Peninsula Borough

SEWARD AIRPORT LEASED LAND TRACTS SW9600019

ALASKA TIDELANDS SURVEY 1874
TRACT A REPLAT

This map is prepared
for Kenai Peninsula
Borough Assessing Dept.
use only and is not
intended for conveyance
nor is it a survey.

Note- Assessor's block Numbers Shown in Elipses
Assessor's Parcel Numbers Shown in Circles