

ER  
LE  
ID.  
RD.

GRIFFIN AVE.  
(20)

RINEHART SUBD.

340

SOLDOTNA AIRPORT KENAI RIVER CENTER

FUNNY RIVER RD.

BK  
135

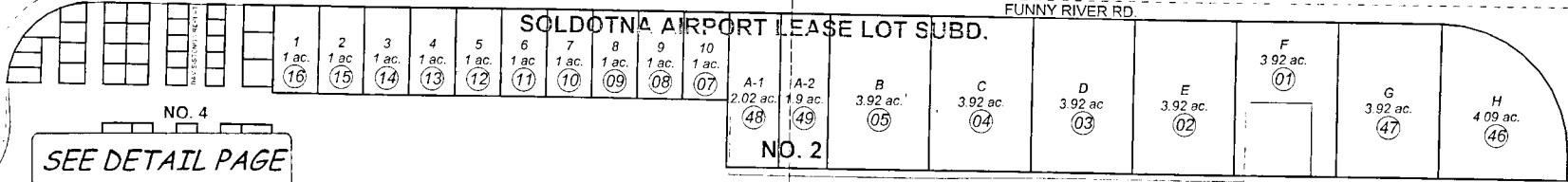

NO. 4

SEE DETAIL PAGE

CENTERLINE OF FAIRWAY

CENTERLINE OF ROADWAY

340

SEC. 33  
SEC. 34

BK  
135



DECEMBER 17, 2003

For 2004 assessment roll

Delete Add Revise

To

50-75

Assessor's Map  
Kenai Peninsula Borough

SOLDOTNA AIRPORT LEASE LOT SUB NO 1 KN0870088  
SOLDOTNA AIRPORT LEASE LOT SUB NO 2 KN0920011  
SOLDOTNA AIRPORT LEASE LOT SUB DAVIS-STENGA REPLAT KN2003073  
SOLDOTNA AIRPORT LEASE LOT SUB NO 4 KN20030080

This map is prepared for Kenai Peninsula Borough Assessing Dept. use only and is not intended for conveyance nor is it a survey  
Note- Assessor's block Numbers Shown in Ellipses  
Assessor's Parcel Numbers Shown in Circles