

SE1/4 NE1/4 SEC. 1, T06S, R13W, S.M.

174-240

230

BRENTON AVE.

GLACIER VIEW RD.

GREENTHUME

STRAWBERRY ST.

060

JODI-LYNN HEIGHTS
SUBDIVISION
UNIT 2

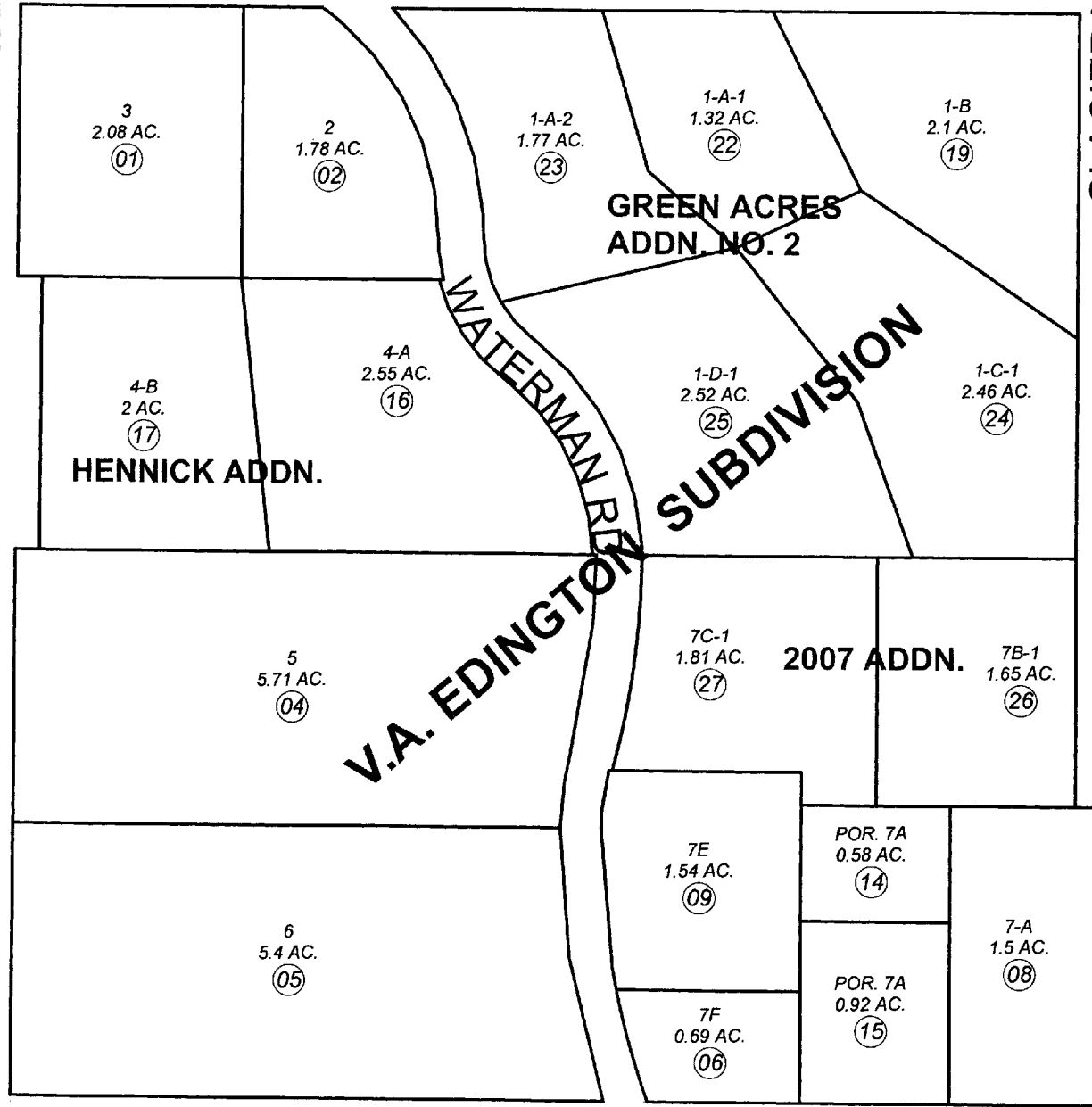

340

GREENTHUMB CTR

ICY B.
NO. 2

260

R13W SEC. 1
R12W SEC. 6

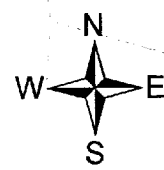

NOVEMBER 13, 2009

For 2010 assessment roll

Delete	Add	Revise
	To	
10,11, 12	26,27	

Assessor's Map
Kenai Peninsula Borough

V A EDINGTON SUB HM0650889
 V A EDINGTON SUB HENNICK ADDN HM0870025
 V A EDINGTON GREEN ACRES ADDN HM0990042
 V A EDINGTON GREEN ACRES ADDN NO 2 HM2003087
 V A EDINGTON 2007 ADDN HM2009038

This map is prepared
 for Kenai Peninsula
 Borough Assessing Dept.
 use only and is not
 intended for conveyance
 nor is it a survey.

Note- Assessor's block Numbers Shown in Elipses
 Assessor's Parcel Numbers Shown in Circles