

POR. SEC. 10, T01S, R01W, S.M.

148-160

130

140

180

150

FIFTH AVE

SIXTH AVE

MONROE ST

MADISON ST

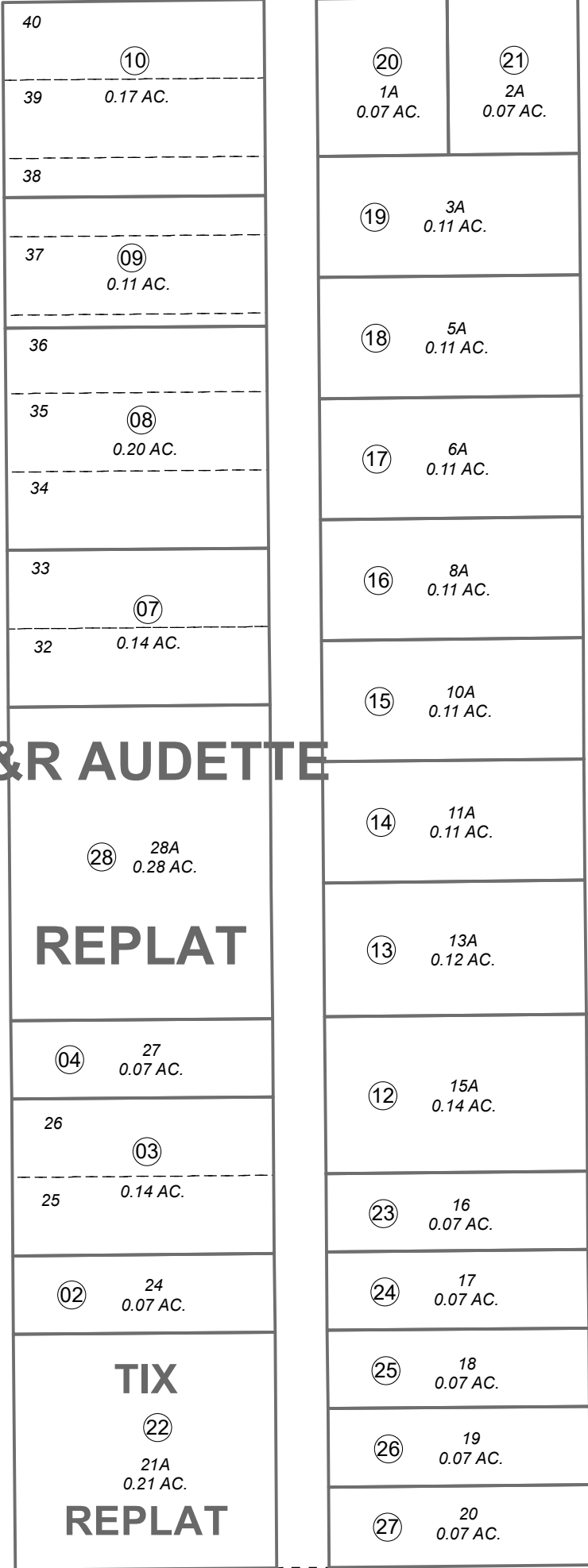

S&R AUDETTE REPLAT

TIX REPLAT



0 25 50 Feet

JUNE 1, 2020

For 2021 assessment roll	
Delete	Revise
To	To
05,06	28

This map is prepared for Kenai Peninsula Borough Assessing Dept. use only and is not intended for conveyance nor is it a survey.

Note- Assessor's block Numbers Shown in Ellipses Assessor's Parcel Numbers Shown in Circles

ORIGINAL TOWNSITE OF SEWARD SW00000001 ORIGINAL TOWNSITE OF SEWARD REPLAT OF BLOCKS 31 & 32 SW00000027 ORIGINAL TOWNSITE OF SEWARD TIX REPLAT SW0990006 SEWARD ORIGINAL TOWNSITE S&R AUDETTE REPLAT SW2020004

Assessor's Map Kenai Peninsula Borough