

ALASKA STATE LAND SURVEY 85-021  
 ALASKA STATE LAND SURVEY 84-153  
 ALASKA STATE LAND SURVEY 85-104  
 ALASKA STATE LAND SURVEY 87-191  
 ALASKA STATE LAND SURVEY 87-190  
 ALASKA STATE LAND SURVEY 91-123  
 ALASKA STATE LAND SURVEY 85-025

AN860078  
 AN870033  
 AN87-128  
 AN890081  
 AN900039  
 AN930027  
 AN940081

SEC. 23, T4N, R18W, (300) SEWARD MERIDIAN

221-182

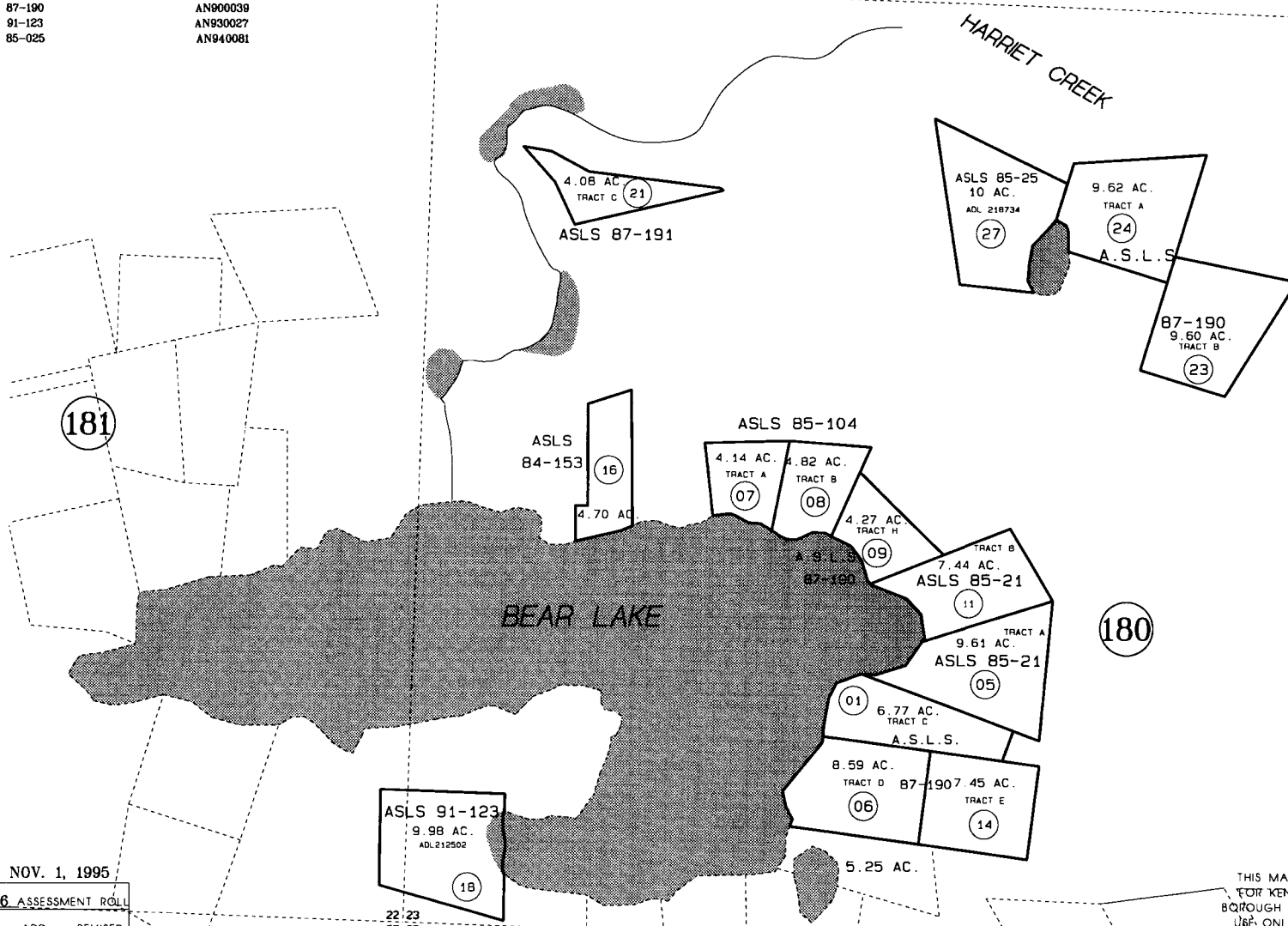

DATE: NOV. 1, 1995  
 FOR 1996 ASSESSMENT ROLL  
 DELETE    ADD    REVISED  
 TO  
 10.15.20

Assessor's Map  
 Kenai Peninsula Borough

THIS MAP IS PREPARED FOR KENAI PENINSULA BOROUGH ASSESSING DEPT. USE ONLY AND IS NOT INTENDED FOR ANY OTHER USE OR REPRESENTATION.

NOTE - Assessor's Block Numbers Shown in Ellipses  
 Assessor's Parcel Numbers Shown in Circles