

POR. GOV'T LOT 9, SEC. 24, T05N, R11W, S.M.

055-120

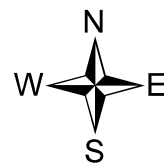
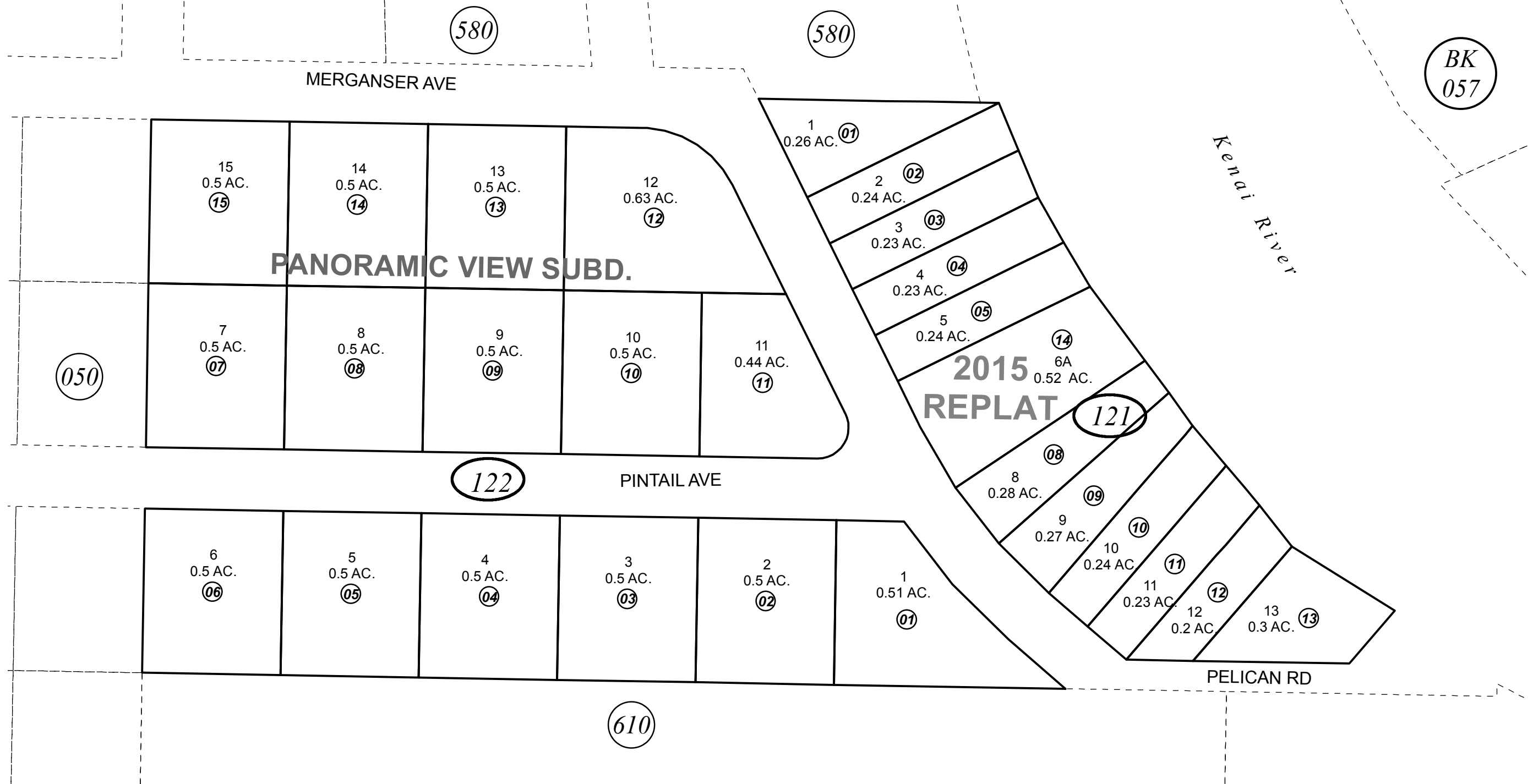

0 25 50 100 Feet

DECEMBER 3, 2015

For 2016 assessment roll		
Delete	Add	Revise
	To	
12106		
12107	12114	

Assessor's Map  
Kenai Peninsula Borough

PANORAMIC VIEW SUB KN0001419  
PANORAMIC VIEW SUB 2015 REPLAT KN2015075

This map is prepared for Kenai Peninsula Borough Assessing Dept. use only and is not intended for conveyance nor is it a survey.  
Note- Assessor's block Numbers Shown in Ellipses  
Assessor's Parcel Numbers Shown in Circles